

Eye-LED



Product Description

Miniature LED Spotlight

Eye-LED is a miniature LED spotlight perfect for all applications with minimal installation dimensions. With Eye-LED you can add accent lighting with a small footprint in the most challenging applications.

Product Features

- Available color temperatures:
 - 3000 K
 - 5000 K
 - Additional color temperatures (special order)
- 51" connecting cable with plug-in connector attached
- Small dimensions: recess depth 1/2", recess diameter 1"
- Dimmable with available accessories
- Stainless Steel or Brushed Aluminum finish
- Approved for use in closet applications
- To be used with 350 mA Constant Current Driver
- Good CRI >75
- Efficacy: 80 lm/W
- Energy-efficient using only 1 W





Available Options

Necessary Accessories on Page 69

MODEL	DIAMETER	POWER	LIGHT OUTPUT	EFFICACY	CRI	FINISH	PART NO. (3000 K)	PART NO. (5000 K)
Eye-LED	1 1/32"	1 W	80 Lm	80 lm/W	>75	Stainless Steel	EYELEDSS/WW	EYELEDSS/CW
Eye-LED	1 1/32"	1 W	80 Lm	80 lm/W	>75	Aluminum	EYELEDA/WW	EYELEDA/CW

Compatible Drivers on Page 64

Dimensions

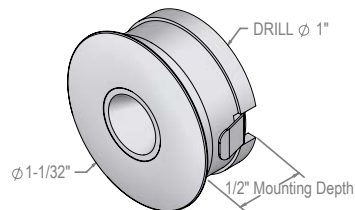

Low Voltage Drivers

Constant Voltage Drivers

24 Vdc Drivers



Daisy Driver, 30W
(Full Specs on Page #94)



Daisy Driver, 75W
(Full Specs on Page #95)



Daisy Driver, 96W
(Full Specs on Page #96)



Driver, 6W
(Full Specs on Page #98)



Driver, 30W
(Full Specs on Page #99)



Driver, 75W
(Full Specs on Page #100)



Driver, 96W
(Full Specs on Page #101)

Constant Current Drivers

LED Drivers



LED Driver, 10W
(Full Specs on Page #104)



LED Driver, 18W Dimmable
(Full Specs on Page #105)

Compatibility

Constant Voltage Compatible LEDs

SPOT

SR45-LED

FR68-LED

R55-LED

ER-LED

Constant Current Compatible LEDs

SPOT

SR45-LED

SR68-LED

Big6/2-LED

HO-LED

Eye-LED

Non Swivel

ER-LED

Connecting Cables

DESCRIPTION	LENGTH	PART NO.
Power Cable Extension, White	39"	KB12LEDCC39/H
Power Cable Extension, White	84"	KB12LEDCC84/H
Power Cable Extension, White	98"	KB12LEDCC98/H
Power Cable Extension, Black	39"	KB12LEDCC39/BL/H
Power Cable Extension, Black	39"	KB12LEDCC98/BL/H
Power Cable Extension, Black	39"	KB12LEDCC120/BL/H
Terminal Block	39"	PS24V/TB
Terminal Block, DC plug	39"	PS24V/TB/DC/S
Terminal Block, DC, Black	39"	PS24V/TB/DC/BL/S
Power Cord locking clip		CLIP/24V/CCPC

Optional Accessories

DESCRIPTION	PART NO.
Dimming Module	STICKPSDIM/S
Dimming Controller	DIMCONTROL/S
Y-Cable Adapter	STICKDIM/YCABLE
Remote Control Dimmer	RCPSDIM/V2
Rocker Switch	PS24V/SWITCH
Rocker Switch, DC plug	PS24V/SWITCH/DC
24 V Occupancy Switch	PS24V/SW/OC
Sensor Switch	IRSWITCH/H
Sensor Switch, Dimmable	IRSWITCH/H/D

EYE-LED

Connecting Cables

DESCRIPTION	LENGTH	PART NO.
350mA Power Cable Extension, Black	36"	LEDCC36
350mA Power Cable Extension, Black	72"	LEDCC72
350mA Terminal Block, 3 way	98"	TBLED/B

Optional Accessories

DESCRIPTION	PART NO.
Dimming Controller	DIMCONTROL/S
Y-Cable Adapter	STICKDIM/YCABLE