

# Eye-LED



## Product Description

### Miniature LED Spotlight

Eye-LED is a miniature LED spotlight perfect for all applications with minimal installation dimensions. With Eye-LED you can add accent lighting with a small footprint in the most challenging applications.

## Product Features

- Available color temperatures:
  - 3000 K
  - 5000 K
  - Additional color temperatures (special order)
- 51" connecting cable with plug-in connector attached
- Small dimensions: recess depth 1/2", recess diameter 1"
- Dimmable with available accessories
- Stainless Steel or Brushed Aluminum finish
- Approved for use in closet applications
- To be used with 350 mA Constant Current Driver
- Great CRI >90
- Efficacy: 94 lm/W
- Energy-efficient using only 1 W

## Product Details





Available Options

Necessary Accessories on Page 78

MODEL	DIAMETER	POWER	LIGHT OUTPUT	EFFICACY	CRI	FINISH	PART NO. (3000 K)	PART NO. (5000 K)
Eye-LED	1 1/32"	1 W	94 Lm	94 lm/W	>90	Stainless Steel	EYELEDSS/WW	EYELEDSS/CW
Eye-LED	1 1/32"	1 W	94 Lm	94 lm/W	>90	Aluminum	EYELEDA/WW	EYELEDA/CW

Compatible Drivers on Page 72

Dimensions

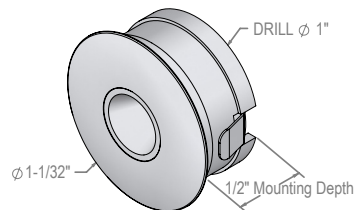

# Low Voltage Drivers

## Constant Voltage Drivers

### 24 Vdc Drivers



**Daisy Driver, 30W**  
(Full Specs on Page #94)



**Daisy Driver, 75W**  
(Full Specs on Page #95)



**Daisy Driver, 96W**  
(Full Specs on Page #96)



**Driver, 6W**  
(Full Specs on Page #98)

## Constant Current Drivers

### LED Drivers



**LED Driver, 10W**  
(Full Specs on Page #104)



**LED Driver, 18W Dimmable**  
(Full Specs on Page #105)

# Compatibility

## Constant Voltage Compatible LEDs

---

### SPOT

---

SR45-LED

FR68-LED

Eco78-LED

R55-LED

ER-LED

## Constant Current Compatible LEDs

---

### SPOT

---

SR45-LED

SR68-LED

Big6/2-LED

HO-LED

Eye-LED

# Spot-LED Accessories

## EYE-LED

### Connecting Cables

DESCRIPTION	LENGTH	PART NO.
350mA Power Cable Extension, Black	36"	LEDCC36
350mA Power Cable Extension, Black	72"	LEDCC72
350mA Terminal Block, 3 way	98"	TBLED/B

### Optional Accessories

DESCRIPTION	PART NO.
Dimming Controller	DIMCONTROL/EURO
Y-Cable Adapter	STICKDIM/YCABLE